



18 Queensway North Hersham Surrey KT12 5QW

£2100pcm + Initial deposit



QUEENSWAY NORTH KT12

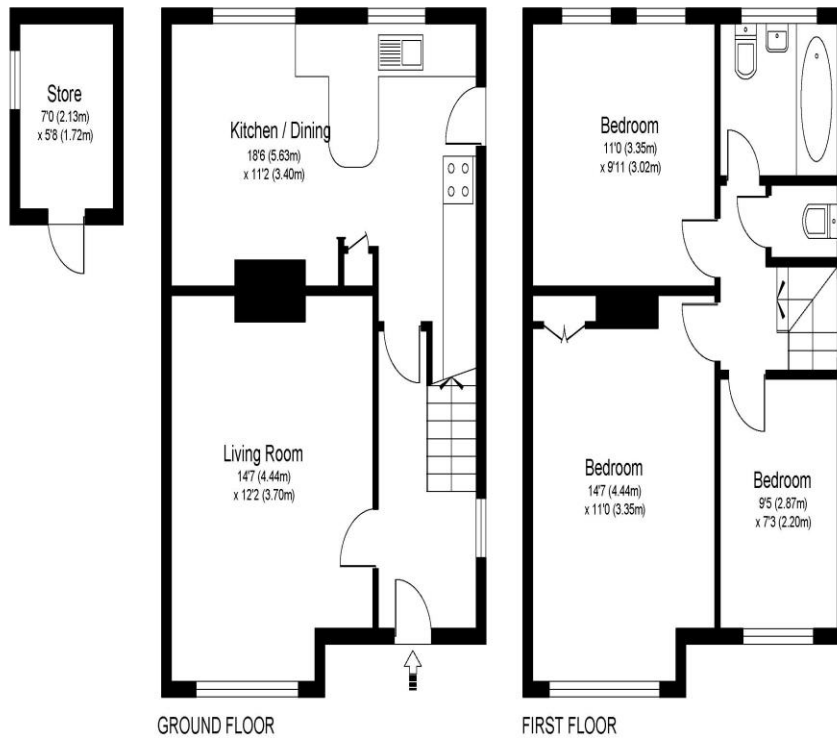

Approximate Gross Internal Floor Area: 82m sq / 882 sq ft

Whilst every attempt has been made to ensure the accuracy of the floor plan contained here, measurements of doors, windows and rooms are approximate and no responsibility is taken for any error, omission or misstatements. These plans are not to scale and are for representation purposes only as defined by RICS Code of Measuring Practice and should be used as such by any prospective purchaser. Specifically no guarantee is given on total square footage of the property if quoted on this plan. Any figure given is for initial guidance only and should not be relied on as a basis of valuation.

A three-bedroom, semi-detached home well located for local schools with off-street parking and rear garden. Internally this home has a good feel to it and offers good accommodation suited to the family market. On the first floor there are two good size double rooms with a third single and two toilets. On the ground floor there is a front lounge room and to the rear an open plan kitchen/diner opening onto the garden. The garden is nice with a lawn and patio area with a feature covered sitting area. There is also plenty of garden storage with a brick built shed and a traditional shed, To the front of the house is off-street parking with space for approximately three cars. Well-located within a good position for local schools including Bell Farm and Three Rivers Academy. Available unfurnished from 27th June 2024.

EPC Rating E.



AGENTS NOTES: These details do not constitute any part of an offer or contract. In issuing them we do not have any authority to give any warranty or representation whatsoever in respect of this property. These details are provided without any responsibility on our part or the part of the vendors. No statements in these details are to be relied upon as representations of fact and purchasers should satisfy themselves by inspection or otherwise as to the accuracy of the statements contained therein.

Equipment: We have not tested the equipment or central heating system mentioned in these particulars and purchasers are advised to satisfy themselves as to their working order and condition.

Measurements: Great care is taken when measuring but measurements should not be relied upon for ordering carpets, equipment, etc.